



An ISO 9001:2015 Certified Company



SECTION DRAWING CATALOGUE

AALCO IMPEX PRIVATE LIMITED

Plot No:16, SIPCOT Industrial Complex, Gummidipoondi, Chennai - 601201

Contact :+91 7540004194, 97 & 98, Email: info@aalco.in, Website : www.aalco.in

Specification

Table -1
Wrought alloy - Chemical composition limits (%)

Alloy (ISS) Old	Alloy New	Equivalent Alloy (A.A) U.S.A	Copper		Magnesium		Silicon		Iron Max.	Manganese		* Others (Total) Max.	Remarks
			Min.	Max.	Min.	Max.	Min.	Max.		Min.	Max.		
H 20	65032	—	0.15	0.40	0.70	1.20	0.40	0.80	0.70	0.20	0.80	0.40	*Cr = 0.15 - 0.35 %
—	—	6061	0.15	0.40	0.80	1.20	0.40	0.80	0.70	—	0.15	0.40	Chromium 0.04 to 0.35
H 9	63400	6063	—	0.10	0.40	0.90	0.30	0.70	0.60	—	0.30	0.40	
91E	63401	6101	—	0.05	0.40	0.90	0.30	0.70	0.50	—	0.03	0.10	
—	64401	6201	—	0.10	0.60	0.90	0.50	0.90	0.50	—	0.03	0.10	
H 30	64430	6351	—	0.10	0.40	1.20	0.60	1.30	0.60	0.40	1.00	0.30	
—	—	6082	—	0.10	0.60	1.20	0.70	1.30	0.50	0.40	1.00	0.30	Chromium upto 0.25

*Either Mn or Cr shall be present

Table -2
Wrought alloy - Near equivalent designations

INDIA		U.S.A (A.A)	BRITAIN (B.S)	CANADA	GERMANY (DIN)	RUSSIA	I.S.O	FRENCH
NEW I.S.	OLD I.S							
65032	H20	6061	H20	65S	Al-Mg-Si Cu	—	Al-Mg-1Si Cu	—
63400	H9	6063	H9	50S	Al-Mg-Si 0.5	—	Al-Mg-Si	—
64430	H30	6351	H30	B51S	Al-Mg-Si 1	AV	Al-Si 1 Mg	6081
63401	91E	6101	91E	D50S	E.Al-Mg-Si 0.5	—	—	—
64401	—	6201	—	—	—	—	—	—

Table - 3
Wrought alloy - Guide to selection

Alloy	Temper	Resistance to Corrosion	Workability (Cold)	Machinability	Brazeability	Weldability	Common available forms	Indications of Use
6061 (H 20) (65032)	O, F	A	A	D	A	A	Rods, Flats, Tube & Other sections	Heavy duty structures, Building hardware, Sections for bus body, truck and rail coach, furniture, rivets etc.
6063 (H 9)	O, F T4 T5 T6	A A A A	A B C C	D C C C	A A A A	A A A A	Rods, Flats, Tube & Other sections	Building hardware, architectural sections with good surface finish, medium strength furniture and anodized sections
6101 (91E) (63401)	T4 T6	A A	B B	C C	A A	A A	Rods, Flats, Tube & Other sections	High strength electrical busbar sections.
6201 (64401)	T4	A	A	C	A	A	Redraw Rod	Overhead conductors, ACAR and AAAC
6351 (H 30) (64430)	O, F T4 T6	A A A	A C D	D C C	A A A	A A A	Rods, Flats, Tube & Other sections	Structural and general engineering items such as rail & road transport vehicles, bridges, cranes, roof trusses, rivers etc.

Notes:

- Relative readings for corrosion, workability and machinability in decreasing order of merit A,B,C and D.
- Weldability and brazeability ratings A,B,C and D are relative ratings defined as follows:
 - A - Generally weldable by the commercial procedure & methods.
 - B - Weldable with special technique.
 - C - Limited weldability due to crack sensitivity or loss in corrosion resistance and mechanical properties.
 - D - Generally not Weldable.
- Availability of other forms subject to special enquiries and methods.

Table - 4
Wrought Aluminium & Aluminium Alloy: - Mechanical and Electrical Properties

Alloy	Temper Designation	Tensile strength Min.	0.2 Percent Proof Stress Min.	Percent Elongation on 5.65 Sa Min.	Electrical Conductivity at 20°C, Min.	Maximum Electrical Resistivity at 20° C	Thickness	Inside bend radius Min.	Co-efficient of Thermal expansion	Thermal Conductivity
A.A	I.S.	Mpa.	Mpa.		% IACS	Ohm mm/mm ²			Per °C at 20°C typical	CGS at 25°C typical
6101 63401	W	140	80	12	-	-	-	-	-	-
6101 63401	WP (Range 1)	170	135	12	56.50	0.03052	3.00 to 9.50	1 x thickness	23.4 X 10 ⁻⁶	0.52
6101 63401	WP (Range 1)	200	170	10	55.00	0.03135	3.00 to 9.50	2 x thickness	23.4 X 10 ⁻⁶	0.52
6201	T 81	-	-		52.50	0.03283			23.5 X 10 ⁻⁶	0.50

NOTE:

1Mpa = 1 N/mm² = 0.102 Kg/mm²

If required the cross section shall be calculated from the mass and length of a straight test piece taking density 2.700 for grade 63401

Content

Flat bar.....	01
Square bar.....	01
Square Tube.....	02
Rectangular Tube.....	02
Equal Angle.....	03
Unequal Angle.....	03
Bulb TEE.....	04
Single 'U' Channel.....	04
Double Glass Channel.....	05
Hinges.....	05
Handle.....	05
Single Partition.....	06
Double Partition.....	06
Door Centre.....	07
Door Top.....	07
Door Bottom.....	08
Door Middle Section.....	08
Door Vertical.....	09
Glazing Plate	10
Clip	10
Fish Bottom	10
Shutter B/S/O (18mm Series).....	11
Shutter O/S/O (18mm Series).....	11
Shutter Interlock (18mm Series).....	11
2 Track Side and Top (18mm Series)	12
2 Track Bottom (18mm Series).....	12
2 Track Side and Top (20mm Series)	13
3 Track Side and Top (20mm Series)	13
3 Track Bottom (20mm Series).....	13
Shutter B/S/O (15mm Series).....	14
Shutter Interlock (15mm Series).....	14
2 Track Side and Top (15mm Series)	14

Content

Casement Window.....	15
Curtain Wall.....	16
Sky Light Bottom.....	17
Sky Light Top.....	17
Modular Furniture.....	17
Louver.....	17
A/C Grill.....	18
Solar Panel.....	19
Industrial sections.....	23
F- Section.....	24
G- Section.....	24
Half Round.....	25
Radius Flat.....	25
Pathway Beading.....	25
Mazda Section.....	26
Hi tech Mazda Section.....	26
Andra Mazda.....	27
Dick Beading.....	28
Valvo Section.....	28
Hi tech Valve Section.....	28
ACP Beading	28
C - Channel.....	29
Step Angle	29
Sooting - H.....	30
Key Gola.....	30
J - Water Channel.....	30
Rail coach.....	30
Roman Blinds.....	31
Netlon.....	31
Mosquito Net.....	32

General Information

Standard Manufacturing Tolerances

The standard manufacturing tolerance given here are applicable to the average shape. Wider tolerance may be required for some shapes, and closer tolerance may be possible for others.

Tolerances stricter than standard shall be subjected to special enquiry.

Table - 6
Round Bars / Rods : Diameter Tolerance

Specified Diameter (mm)	Tolerance (mm)		
	Class A		Class B
	(+)	(-)	
Upto 12.0	0.03	0.07	±0.20
Over 12.0 Upto 25.0	0.05	0.10	±0.25
Over 25.0 Upto 40.0	0.07	0.13	±0.30
Over 40.0 Upto 50.0	0.13	0.13	±0.38
Over 50.0 Upto 56.0	0.15	0.15	±0.46
Over 56.0 Upto 71.0	0.20	0.20	±0.53
Over 71.0 Upto 80.0	0.25	0.25	±0.61
Over 80.0	0.5% of Diameter	0.5% of Diameter	± 1% of Diameter

Note :

Class 'A' is for Drawn rods.

Class 'B' is normal tolerance for extruded rods.

Table - 7
Solid Sections : Width Tolerance (at closed ends)

Specified Width or Width across flats (mm)	Tolerance (mm)	Specified Width or Width across flats (mm)	Tolerance (mm)
4	± 0.18	40	± 0.46
5	± 0.20	50	± 0.46
6	± 0.20	60	± 0.53
8	± 0.23	80	± 0.69
10	± 0.23	100	± 0.69
12	± 0.25	120	± 0.76
16	± 0.28	160	± 1.02
20	± 0.30	200	± 1.14
25	± 0.30	250	± 1.40
32	± 0.38		

Note :

1. For Intermediate size, take tolerance for the next higher value
2. Width tolerances on open ends of solid sections such as Channels, I-Beams, etc. are given separately in Table -8

General Information

Table - 8
Solid Sections : Width Tolerance (at open ends)

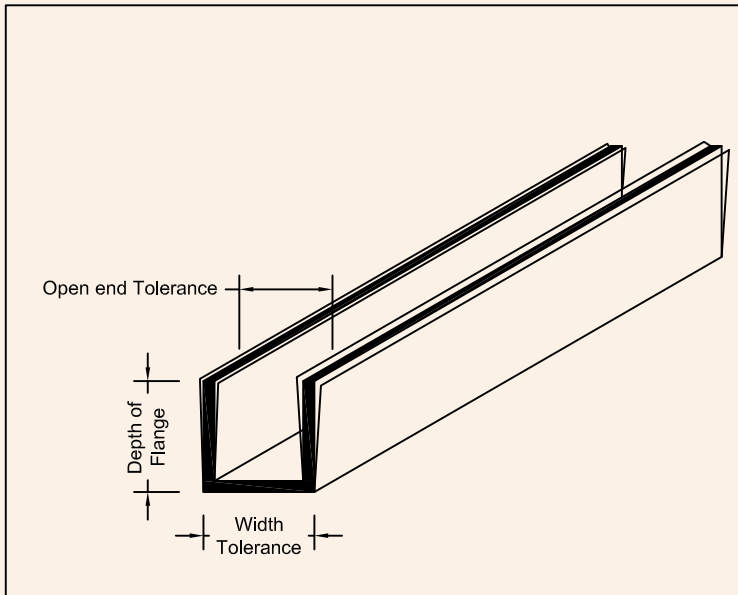

Displacement of any one leg to be controlled
Independently by tolerance on angle

Tolerance on open ends of channels and I-beams

Specified Width mm	Depth of flange or leg (mm)			
	Width Tolerance mm ±			
	6.5 to 16.0	16.1 to 32.0	32.1 to 64.0	64.1 to 150.0
Upto 6.0	0.30	—	—	—
6.1 to 12.0	0.35	0.40	0.45	—
12.1 to 20.0	0.40	0.45	0.50	—
20.1 to 25.0	0.45	0.50	0.55	0.65
25.1 to 38.0	0.50	0.55	0.65	0.75
38.1 to 50.0	0.60	0.70	0.80	0.90
50.1 to 100.0	0.80	0.90	1.20	1.50
100.1 to 150.0	1.10	1.30	1.70	2.00
150.1 to 200.0	1.50	1.60	2.10	2.50
200.1 to 250.0	1.70	1.90	2.70	3.00

Note :

1. Tolerance on either internal or external gap (between flanges or legs) can be guaranteed depending on requirements.
2. Width tolerances at closed ends are given in Table -7
3. Those tolerances are applicable to channels, I-Beams and other such sections where there are both opened and closed ends.

General Information

Table - 9
Solid Sections : Thickness Tolerance (±)

** Specified Thickness (mm)	Width of Section (mm)														
	12	16	20	25	32	40	50	63	80	100	125	160	200	250	320
1.2	0.20	0.20	0.20	0.20	0.20	*	*	*	*	*	*	*	*	*	*
1.6	0.18	0.20	0.20	0.20	0.20	*	*	*	*	*	*	*	*	*	*
2.0	0.18	0.20	0.20	0.20	0.20	0.23	0.25	0.28	0.30	0.33	0.36	0.38	0.41	0.46	*
2.5	0.18	0.20	0.20	0.20	0.20	0.23	0.25	0.28	0.30	0.33	0.36	0.38	0.41	0.46	*
3.2	0.18	0.20	0.20	0.20	0.23	0.25	0.28	0.30	0.33	0.36	0.38	0.41	0.43	0.48	*
4.0	0.20	0.23	0.23	0.23	0.25	0.28	0.30	0.33	0.36	0.38	0.43	0.43	0.46	0.51	*
5.0	0.20	0.23	0.23	0.23	0.25	0.28	0.30	0.33	0.36	0.38	0.41	0.43	0.46	0.51	*
6.0	0.20	0.23	0.23	0.23	0.25	0.28	0.30	0.33	0.36	0.41	0.46	0.51	0.56	0.66	*
8.0	0.23	0.25	0.25	0.25	0.28	0.30	0.33	0.36	0.38	0.43	0.48	0.53	0.58	0.71	*
10.0	0.23	0.25	0.25	0.25	0.28	0.30	0.33	0.36	0.38	0.43	0.48	0.53	0.58	0.71	*
12.0	0.25	0.28	0.28	0.28	0.30	0.33	0.36	0.38	0.41	0.46	0.48	0.53	0.58	0.74	0.97
16.0	0.28	0.30	0.30	0.30	0.33	0.36	0.38	0.41	0.43	0.48	0.51	0.56	0.61	0.76	1.02
20.0	-	0.30	0.30	0.30	0.36	0.38	0.41	0.43	0.46	0.51	0.53	0.61	0.69	0.79	1.04
25.0	-	0.30	0.30	0.30	0.36	0.38	0.41	0.43	0.46	0.51	0.53	0.61	0.69	0.79	1.04
32.0	-	-	-	-	0.38	0.41	0.43	0.46	0.48	0.53	0.56	0.66	0.74	-	-
40.0	-	-	-	-	-	0.46	0.48	0.51	0.53	0.56	0.61	0.71	0.79	-	-
50.0	-	-	-	-	-	-	0.53	0.56	0.58	0.61	0.66	0.76	0.84	-	-
63.0	-	-	-	-	-	-	-	0.61	0.64	0.66	0.71	0.81	0.89	-	-
80.0	-	-	-	-	-	-	-	-	0.69	0.71	0.74	0.86	0.94	-	-
100.0	-	-	-	-	-	-	-	-	-	0.76	0.79	0.91	0.99	-	-
125.0	-	-	-	-	-	-	-	-	-	-	0.89	0.97	1.04	-	-

Note :

- * To be regarded as special sections.
- ** For intermediate size, take tolerance for next higher value.

Table - 10
Round Tubes : Wall Thickness Tolerance (±)

Specified wall Thickness (mm)	Tolerance (mm)	
	Class 1 ±	Class 2 ±
Upto 1.2	0.30	-
1.6	0.30	-
1.8	0.30	-
2.00	0.30	-
2.24	0.30	-
2.50	0.33	-
2.80	0.36	-
3.15	0.40	0.90
3.55	0.43	0.94
4.00	0.48	0.97
4.50	0.51	1.02
5.00	0.56	1.07
5.50	0.61	1.12
6.30	0.67	1.18
7.10	0.76	1.27
8.00	0.97	1.47
9.00	1.10	1.60
10.00	1.22	1.73
11.20	1.28	1.79
12.50	1.35	1.85

Note :

1. Tubes with wall thickness intermediate between standard size will have the tolerance of the next higher wall thickness.
2. Tolerance of standard wall thickness above 12.50 mm may be as agreed to between the purchaser and the supplier.
3. For Al-Zn-Mg, Al-Mg and Al-Cu alloy, Class 2 tolerances shall apply
4. For Al, Al-Mn and Al-Mg-Si alloy, class 1 tolerances

General Information

Table - 11
Round Tube : Diameter Tolerance

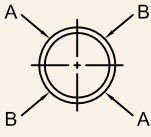
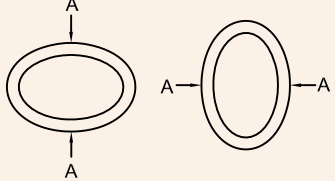
Specified Diameter Outside or Inside (mm)	Allowable Deviation of mean diameter 1/2 (AA+BB) from Specified Diameter (Dia. Tolerance) mm ±	Allowable Deviation of diameter at any point from Specified Diameter (Ovalness Tolerance) mm ±
		
From 9 upto 18	0.25	0.50
Over 18 upto 30	0.30	0.60
Over 30 upto 40	0.36	0.80
Over 40 upto 50	0.45	0.90
Over 50 upto 60	0.54	1.00
Over 60 upto 80	0.60	1.30
Over 80	1% of Dia.	2.5% of Dia.

Note :

1. When outside diameter, inside diameter and wall thickness are all specified, standard tolerances are applicable to any two of these dimensions, but no to all three.
2. Mean diameter is the average of two diameter measurement taken at right angles to each other at any point along the length. In other words mean diameter is 1/2 (AA + BB)
3. Ovalness tolerance is not applicable for annealed temper or if the wall thickness is less than 2.5% of the outside diameter.

Table - 12
Hallow Sections : Wall Thickness Tolerance (±)

Wall Thickness (mm)	Width or Overall dimensions (mm)													
	Over 10.0 Upto 20.0	20.0 33.0	30.0 40.0	40.0 50.0	50.0 60.0	60.0 80.0	80.0 100.0	100.0 120.0	120.0 140.0	140.0 160.0	160.0 180.0	180.0 200.0	200.0 225.0	225.0 250.0
Class B														
Over	Upto													
1.0	1.5	0.28	0.28	0.28	0.30	-	-	-	-	-	-	-	-	-
1.5	2.0	0.30	0.33	0.33	0.36	-	-	-	-	-	-	-	-	-
2.0	2.5	0.33	0.33	0.36	0.38	0.43	0.46	-	-	-	-	-	-	-
2.5	3.0	0.41	0.43	0.46	0.48	0.51	0.53	0.56	-	-	-	-	-	-
3.0	4.0	0.53	0.56	0.58	0.61	0.64	0.66	0.69	0.71	0.74	-	-	-	-
4.0	5.0	-	0.71	0.74	0.76	0.79	0.81	0.84	0.86	0.89	0.91	0.94	1.02	-
5.0	6.0	-	-	0.97	0.99	1.02	1.04	1.07	1.09	1.12	1.14	1.17	1.19	1.22
6.0	8.0	-	-	-	1.22	1.24	1.27	1.30	1.32	1.35	1.37	1.40	1.42	1.45
8.0	10.0	-	-	-	-	1.47	1.50	1.52	1.55	1.57	1.60	1.63	1.65	1.68
10.0	12.0	-	-	-	-	1.73	1.75	1.78	1.80	1.83	1.85	1.88	1.90	1.93
12.0	16.0	-	-	-	-	-	1.98	2.00	2.03	2.06	2.08	2.11	2.13	2.16
16.0	20.0	-	-	-	-	-	-	2.24	2.26	2.29	2.31	2.34	2.36	2.39
20.0	25.0	-	-	-	-	-	-	2.49	2.51	2.54	2.57	2.59	2.62	2.64
Class A														
1.5	2.0	0.28	0.30	0.30	0.33	-	-	-	-	-	-	-	-	-
2.0	2.5	0.30	0.30	0.33	0.36	0.41	0.43	-	-	-	-	-	-	-
2.5	3.0	0.30	0.30	0.36	0.38	0.43	0.46	0.51	-	-	-	-	-	-
3.0	4.0	0.33	0.36	0.38	0.41	0.46	0.51	0.56	0.61	0.69	-	-	-	-
4.0	5.0	-	0.41	0.43	0.46	0.51	0.56	0.61	0.69	0.76	0.84	0.91	0.99	-
5.0	6.0	-	-	0.46	0.51	0.56	0.61	0.69	0.76	0.84	0.91	0.99	1.07	-
6.0	8.0	-	-	-	0.56	0.61	0.69	0.76	0.84	0.91	0.99	1.07	1.14	-
8.0	10.0	-	-	-	-	0.69	0.76	0.84	0.91	0.99	1.07	1.14	1.22	-
10.0	12.0	-	-	-	-	0.76	0.84	0.91	0.99	1.07	1.14	1.22	1.30	-
12.0	16.0	-	-	-	-	-	0.91	0.99	1.07	1.14	1.22	1.30	1.37	-
16.0	20.0	-	-	-	-	-	-	1.07	1.14	1.22	1.30	1.37	1.45	-
20.0	25.0	-	-	-	-	-	-	1.14	1.22	1.30	1.37	1.45	1.52	-

Note :

1. Those tolerances are applicable to hallow sections other than round tubes.
2. For non heat treated alloys, these tolerances are applicable when wall thickness of the section is at least 1.5mm or 1/32 of overall width, whichever is greater.
3. Unless otherwise specified, class B tolerances will be applicable.

General Information

Table - 13
Hallow Sections: Width Tolerance

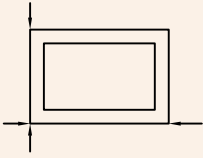
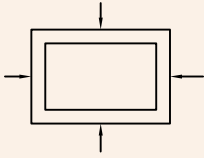
Specified Width or Width across flats (mm)		Width Tolerance \pm When measured at the Corners of the sections	Width Tolerance \pm When measured at the Centres of the sections
Over	Upto		
10.0	20.0	0.30	0.46
20.0	30.0	0.38	0.55
30.0	40.0	0.45	0.65
40.0	50.0	0.52	0.80
50.0	60.0	0.60	1.00
60.0	80.0	0.70	1.20
80.0	100.0	0.80	1.40
100.0	120.0	0.89	1.65
120.0	140.0	1.02	1.90
140.0	160.0	1.14	2.20
160.0	180.0	1.27	2.45
180.0	200.0	1.40	2.70

Note :

- These tolerances are applicable to hallow sections other than round tubes.
- For non heat treatable alloys, these tolerances are applicable when wall thickness of the section is at least 1.5mm or 1/32 of overall width, whichever is greater. For heat treatable alloys, these tolerances are applicable when wall thickness is at least 1.5mm or 1/24 of overall width, whichever is greater.

Table - 14
Solid & Hallow Sections: Angularity Tolerance

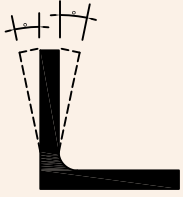
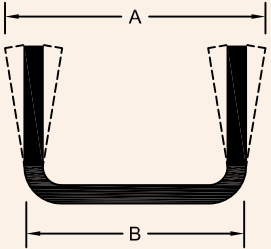
Displacement of any one leg to be controlled independently by angular tolerances	
	
Specified thickness of thinnest leg (mm)	Allowable deviation from specified angle degree
Upto 5.0	$\pm 2.0^\circ$
Over 5.0 Upto 19.0	$\pm 1.5^\circ$
Over 19.0	$\pm 1.0^\circ$

Note :

- Angles should be measured at the extremities of section. If the cases of the sections are convex, the angle should be measured by balancing the arms of the protractor at the middle of section.

General Information

Table - 15
Solid & Hallow Sections: Flatness Tolerance

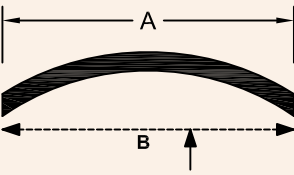

Width of section (mm) A		Tolerance B
Over	Upto & Including	± mm
-	25.0	0.18
25.0	38.0	0.25
38.0	50.0	0.30
50.0	-	0.30 plus 0.13mm for every 25mm of width (See example below)

Example: The tolerances for a solid section of 150mm width shall be as follows:

$$\pm(0.30 + 0.13 \times 150/25) = (0.30 \pm 0.13 \times 6) = \pm 1.08 \text{ mm}$$

Note :

1. Flatness tolerances is measure of concavity or convexity.
2. While measuring convexity, the straight edge shall be balanced at the middle of the section.

Table - 16
Solid & Hallow Sections: Twist & Straightness Tolerance

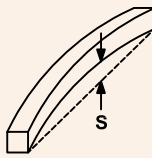
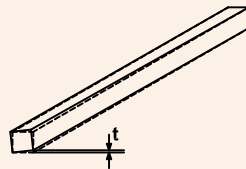
Diameter of circumscribing circle in mm	Allowable deviation from straightness mm per metre or length
Upto & Including 25.0	2.1
Over 25.0	1.7

Note :

1. Tolerance values are same for straightness and twist.
2. Twist is normally measured by placing the extruded section on a flat surface and measuring the maximum distance at any point along its length between the bottom surface of the section and flat surface. From this measurement, the deviation from true straightness of the section is subtracted. The remainder is the twist. To convert the standard twist tolerance to an equivalent inner value, the tangent of the standard tolerance is multiplied by the width of the surface of the section that is one of the flat surface.

Table - 17
Solid & Hallow Section: Cut length Tolerance

Width or Diameter mm	Length tolerance mm
Upto 50.0	± 6
50.1 to 100.0	± 8
100.1 to 150.0	± 10
150.1 and above	± 12

FLAT BAR

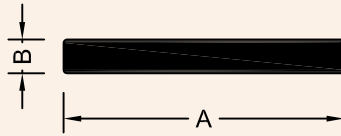

Section No.	A	B	Weight Kgs./12'
2000	12.00	2.00	0.230 Kg
2002	18.00	2.00	0.355 Kg
2003	18.00	3.00	0.535 Kg
2004	18.00	6.00	1.070 Kg
2005	19.00	6.00	1.130 Kg
2006	25.00	3.00	0.740 Kg
2007	25.00	3.00	0.740 Kg
2008	25.00	6.00	1.500 Kg
2009	25.00	10.00	2.420 Kg
2010	25.00	12.00	2.965 Kg
2011	32.00	2.00	0.632 Kg
2012	38.00	3.00	1.130 Kg
2013	38.00	6.00	2.250 Kg
2014	40.00	10.00	3.950 Kg
2015	50.00	2.85	1.408 Kg
2016	50.00	3.00	1.480 Kg
2017	50.00	6.00	2.965 Kg
2018	50.00	10.00	5.000 Kg
2019	50.00	12.00	6.000 Kg
2020	63.00	12.00	7.500 Kg
2021	75.00	6.00	4.450 Kg
2022	75.00	12.00	8.890 Kg
2023	100.00	6.00	5.930 Kg
2024	125.00	6.00	7.412 Kg

SQUARE BAR

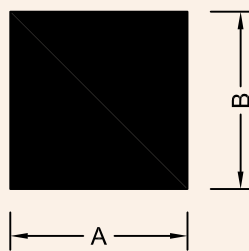

Section No.	A	B	Weight Range - Kgs. /12'
2100	12.70	12.70	1.550 - 1.650

SQUARE TUBE

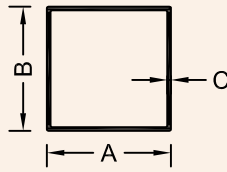

Section No.	A	B	C	Weight Range - Kgs. /12'
4000	25.00	25.00	0.75	0.650 - 0.800
4001	25.00	25.00	0.88	0.800 - 0.950
4002	25.00	25.00	1.05	0.950 - 1.100
4003	25.00	25.00	1.25	1.100 - 1.250
4004	25.00	25.00	1.40	1.250 - 1.400
4005	38.00	38.00	0.82	1.100 - 1.300
4006	38.00	38.00	0.95	1.300 - 1.500
4007	38.00	38.00	1.10	1.500 - 1.750
4008	38.00	38.00	1.30	1.750 - 2.000
4009	38.00	38.00	1.50	2.000 - 2.250
4010	38.00	38.00	2.00	2.750 - 3.100
4011	50.00	50.00	1.00	1.750 - 2.000
4012	50.00	50.00	1.10	2.000 - 2.250
4013	50.00	50.00	1.50	2.800 - 3.200
4014	50.00	50.00	2.00	3.700 - 4.100

RECTANGULAR TUBE

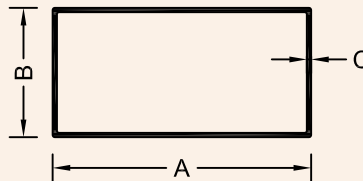

Section No.	A	B	C	Weight Range - Kgs. /12'
4100	25.00	20.00	1.60	1.200 - 1.400
4101	36.00	24.00	0.68	0.700 - 0.900
4102	38.00	24.00	0.70	0.900 - 1.150
4103	38.00	24.00	0.83	1.100 - 1.300
4104	48.00	24.00	0.72	0.900 - 1.100
4105	48.00	24.00	0.84	1.100 - 1.300
4106	48.00	24.00	1.00	1.300 - 1.500
4107	48.00	24.00	1.10	1.500 - 1.750
4108	48.00	24.00	1.28	1.750 - 2.000
4109	48.00	24.00	1.48	2.000 - 2.250
4110	48.00	24.00	1.66	2.250 - 2.500
4111	48.00	24.00	2.00	2.800 - 3.200
4112	48.00	24.00	2.80	3.700 - 4.100
4113	63.00	38.00	0.90	1.700 - 1.900
4114	63.00	38.00	1.00	1.900 - 2.100
4115	63.00	38.00	1.10	2.100 - 2.300
4116	63.00	38.00	1.22	2.300 - 2.500
4117	63.00	38.00	1.30	2.500 - 2.700
4118	63.00	38.00	1.40	2.700 - 2.900
4119	63.00	38.00	1.52	2.900 - 3.100
4120	63.00	38.00	1.70	3.100 - 3.500
4121	63.00	38.00	1.96	3.700 - 4.100
4122	63.00	38.00	2.20	4.000 - 4.300
4123	63.00	38.00	3.10	5.600 - 6.000

EQUAL ANGLE

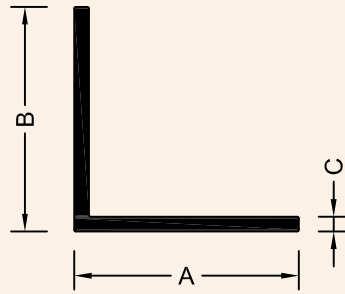

Section No.	A	B	C	Weight Range - Kgs. /12'
1000	19.05	19.05	2.00	0.700 - 0.800
1001	19.05	19.05	2.50	0.800 - 0.900
1002	25.00	25.00	0.60	0.250 - 0.350
1003	25.00	25.00	0.85	0.350 - 0.450
1004	25.00	25.00	1.05	0.450 - 0.550
1005	25.00	25.00	1.25	0.550 - 0.650
1006	25.00	25.00	1.50	0.650 - 0.750
1007	25.00	25.00	1.60	0.750 - 0.850
1008	25.00	25.00	1.90	0.850 - 0.950
1009	25.00	25.00	2.00	0.950 - 1.050
1010	32.00	32.00	1.00	0.600 - 0.700
1011	38.00	38.00	2.50	1.700 - 1.900
1012	50.00	50.00	3.20	2.900 - 3.200

UNEQUAL ANGLE

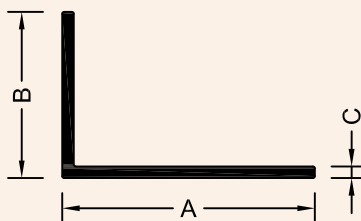

Section No.	A	B	C	Weight Range - Kgs. /12'
1013	38.00	25.00	1.75	1.100 - 1.200
1014	38.00	25.00	1.82	1.200 - 1.400
1015	38.00	25.00	2.50	1.400 - 1.600
1016	38.00	25.00	2.85	1.600 - 1.800

BULB TEE

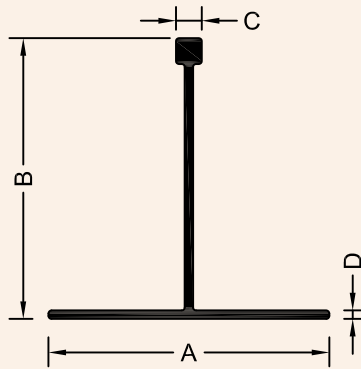

Section No.	A	B	C	D	Weight Range - Kgs. /12'
1100	25.00	25.00	2.50	0.55	0.250 - 0.350
1101	25.00	25.00	2.30	0.75	0.350 - 0.450
1102	25.00	25.00	2.30	0.80	0.450 - 0.550
1103	25.00	25.00	2.30	1.05	0.550 - 0.650
1104	32.00	32.00	3.20	1.15	0.700 - 0.800
1105	32.00	32.00	3.20	1.50	0.900 - 1.000
1106	32.00	32.00	3.20	1.60	1.000 - 1.100
1107	38.00	38.00	3.50	1.15	1.000 - 1.100
1108	38.00	38.00	3.50	1.50	1.100 - 1.200

**SINGLE CHANNEL
U- CHANNEL**

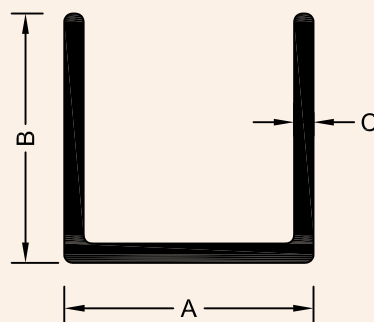

Section No.	A	B	C	Weight Range - Kgs. /12'
5001	9.00	9.00	0.70	0.200 - 0.300
5002	12.00	12.00	0.95	0.300 - 0.400

DOUBLE GLASS CHANNEL

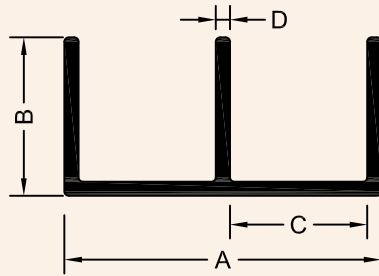

Section No.	A	B	C	D	Weight Range - Kgs. /12'
5100	22.00	11.00	9.53	0.80	0.300 - 0.400
5101	22.00	11.00	9.53	0.95	0.400 - 0.500
5102	22.00	11.00	9.53	1.12	0.500 - 0.600

DOUBLE GLASS CHANNEL

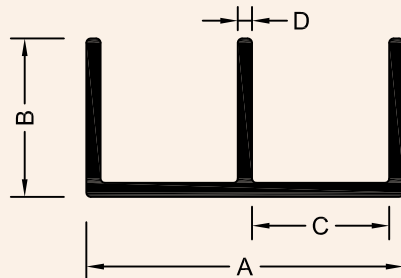

Section No.	A	B	C	D	Weight Range - Kgs. /12'
5103	29.00	14.50	13.40	0.70	0.400 - 0.500
5104	29.00	14.50	13.40	0.80	0.500 - 0.600

HINGES

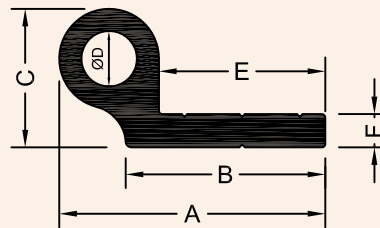

Section No.	A	B	C	ØD	E	F	Weight Range - Kgs. /12'
1201	24.00	18.00	12.50	5.00	15.00	3.00	0.950 - 1.150

HANDLE

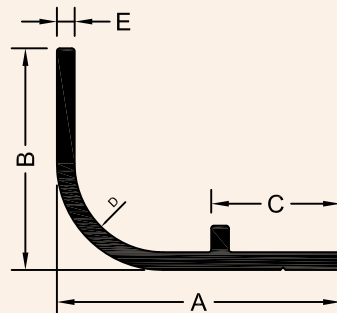

Section No.	A	B	C	D	E	Weight Range - Kgs. /12'
1202	32.00	25.00	14.60	R 10	2.00	0.950 - 1.150

SINGLE PARTITION

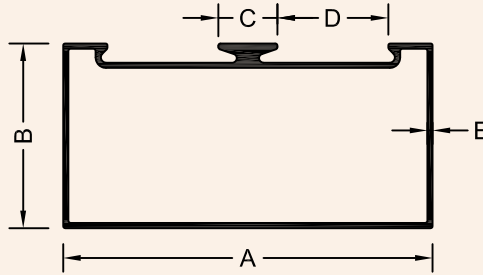

Section No.	A	B	C	D	E	Weight Range - Kgs. /12'
5201	50.00	25.00	8.00	15.00	0.68	1.000 - 1.200
5202	50.00	25.00	8.00	15.00	0.70	1.200 - 1.400
5203	63.00	38.00	8.00	15.00	0.80	1.700 - 1.900
5204	63.00	38.00	8.00	15.00	0.97	1.900 - 2.100
5205	63.00	38.00	8.00	15.00	1.10	2.100 - 2.300
5206	63.00	38.00	8.00	15.00	1.22	2.300 - 2.500
5207	63.00	38.00	8.00	15.00	1.35	2.500 - 2.750
5208	63.00	38.00	8.00	15.00	1.48	2.750 - 3.000
5209	63.00	38.00	8.00	15.00	1.61	3.000 - 3.250
5210	63.00	38.00	8.00	15.00	1.74	3.250 - 3.500
5211	63.00	38.00	8.00	15.00	1.87	3.600 - 4.000
5212	63.00	38.00	8.00	15.00	2.50	4.750 - 5.200
5213	63.00	38.00	8.00	15.00	3.00	5.800 - 6.100

DOUBLE PARTITION

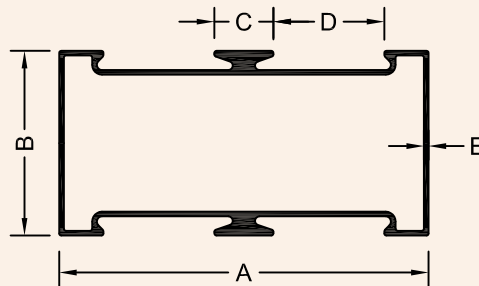

Section No.	A	B	C	D	E	Weight Range - Kgs. /12'
5214	50.00	25.00	8.00	15.00	0.68	1.000 - 1.200
5215	50.00	25.00	8.00	15.00	0.70	1.200 - 1.400
5216	63.00	38.00	8.00	15.00	0.80	1.700 - 1.900
5217	63.00	38.00	8.00	15.00	0.97	1.900 - 2.100
5218	63.00	38.00	8.00	15.00	1.10	2.100 - 2.300
5219	63.00	38.00	8.00	15.00	1.22	2.300 - 2.500
5220	63.00	38.00	8.00	15.00	1.35	2.500 - 2.750
5221	63.00	38.00	8.00	15.00	1.48	2.750 - 3.000
5222	63.00	38.00	8.00	15.00	1.61	3.000 - 3.250
5223	63.00	38.00	8.00	15.00	1.74	3.250 - 3.500
5224	63.00	38.00	8.00	15.00	1.87	3.600 - 4.000
5225	63.00	38.00	8.00	15.00	2.50	4.750 - 5.200
5226	63.00	38.00	8.00	15.00	3.00	5.800 - 6.100

DOOR CENTER

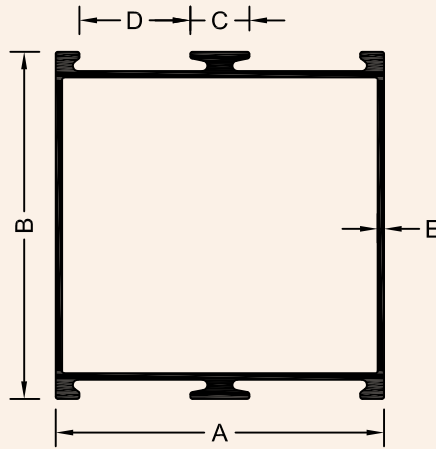

Section No.	A	B	C	D	E	Weight Range - Kgs. /12'
5227	45.45	47.00	8.00	15.00	0.88	2.000 - 2.250
5228	45.45	47.00	8.00	15.00	1.00	2.250 - 2.500
5229	45.45	47.00	8.00	15.00	1.28	2.500 - 2.750
5230	45.45	47.00	8.00	15.00	1.48	2.800 - 3.200
5231	45.45	47.00	8.00	15.00	2.10	3.800 - 4.200

DOOR TOP

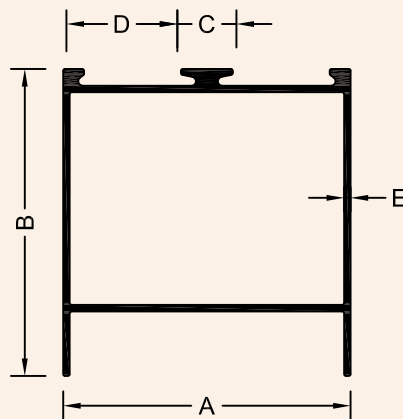

Section No.	A	B	C	D	E	Weight Range - Kgs. /12'
5232	45.45	47.50	8.00	15.00	1.10	2.000 - 2.250
5233	45.45	47.50	8.00	15.00	1.30	2.250 - 2.500
5234	45.45	47.50	8.00	15.00	1.60	2.800 - 3.200
5235	45.45	47.50	8.00	15.00	2.25	3.800 - 4.200

DOOR BOTTOM

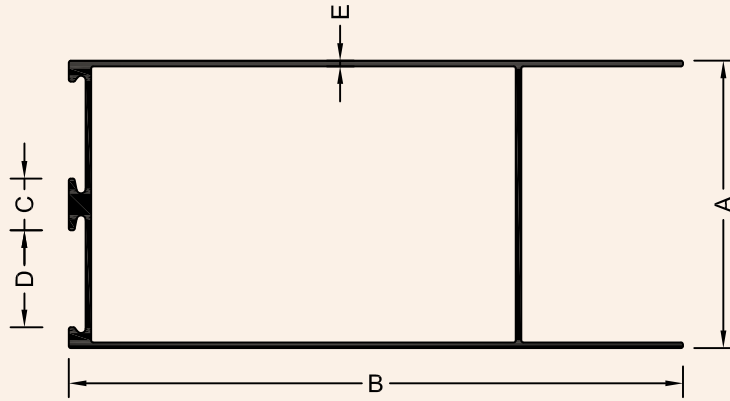

Section No.	A	B	C	D	E	Weight Range - Kgs. /12'
5236	45.45	95.00	8.00	15.00	1.00	2.600 - 3.000
5237	45.45	95.00	8.00	15.00	1.08	3.000 - 3.400
5238	45.45	95.00	8.00	15.00	1.22	3.400 - 3.800
5239	45.45	95.00	8.00	15.00	1.37	3.800 - 4.200
5240	45.45	95.00	8.00	15.00	1.52	4.200 - 4.600
5241	45.45	95.00	8.00	15.00	1.70	4.600 - 5.000
5242	45.45	95.00	8.00	15.00	2.60	6.800 - 7.400

DOOR MIDDLE SECTION

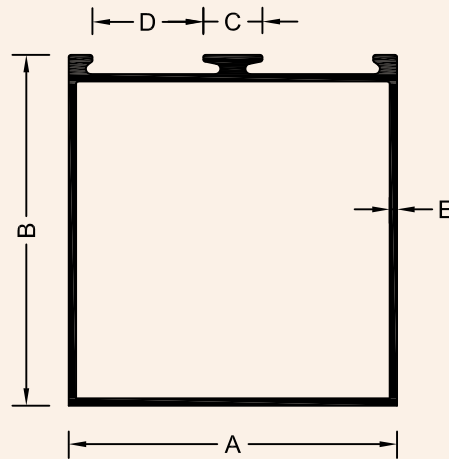

Section No.	A	B	C	D	E	Weight Range - Kgs. /12'
5243	45.45	47.50	8.00	15.00	1.10	2.000 - 2.250
5244	45.45	47.50	8.00	15.00	1.20	2.250 - 2.500

1 3/4" DOOR VERTICLE

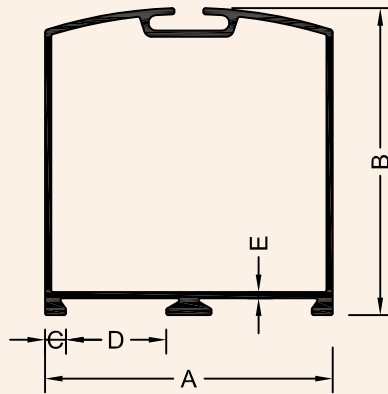

Section No.	A	B	C	D	E	Weight Range - Kgs. / 7'
5245	44.50	47.50	3.25	15.50	0.88	1.000 - 1.250
5246	44.50	47.50	3.25	15.50	1.10	1.250 - 1.500
5247	44.50	47.50	3.25	15.50	1.36	1.500 - 1.750
5248	44.50	47.50	3.25	15.50	1.61	1.750 - 2.000
5249	44.50	47.50	3.25	15.50	1.87	2.000 - 2.250
5250	44.50	47.50	3.25	15.50	2.50	2.500 - 2.750

85MM DOOR VERTICAL

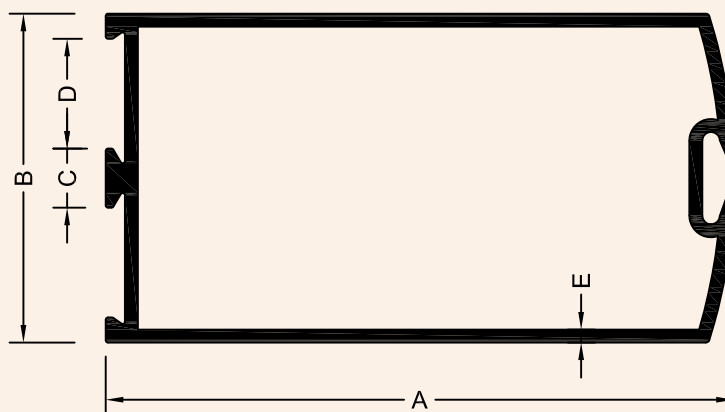

Section No.	A	B	C	D	E	Weight Range - Kgs. / 7'
5251	85.00	44.50	8.00	14.86	1.75	2.500 - 2.750
5252	85.00	44.50	8.00	14.86	1.95	2.800 - 3.200

GLAZING PLATE

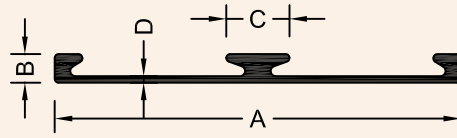

Section No.	A	B	C	D	Weight Range - Kgs. /12'
5253	44.00	3.09	6.84	0.55	0.400 - 0.500
5254	44.50	3.20	8.00	0.65	0.500 - 0.600
5255	44.50	3.20	8.00	0.90	0.600 - 0.700

CLIP

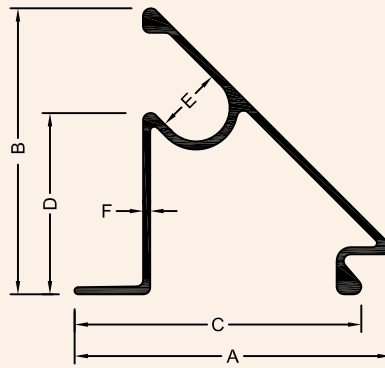

Section No.	A	B	C	D	E	F	Weight Range - Kgs. /12'
5257	19.02	17.20	17.25	10.90	4.04	0.42	0.220 - 0.240

FISH BOTTOM

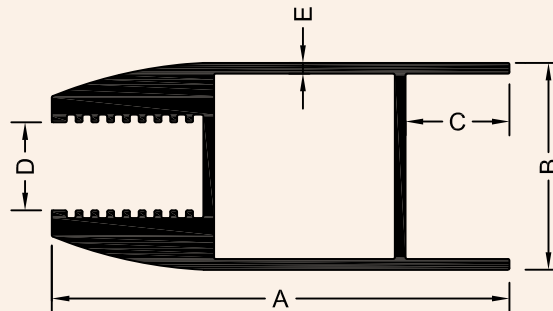

Section No.	A	B	C	D	E	Weight Range - Kgs. /12'
5256	88.50	40.00	20.10	17.00	2.08	8.500 - 9.000

SHUTTER - B/S/O (18MM SERIES)

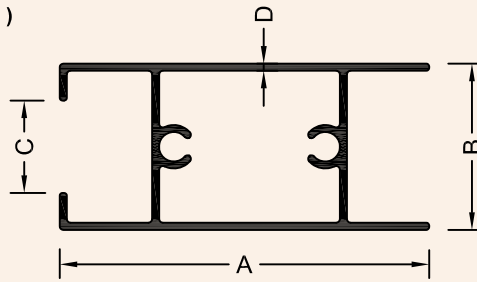

Section No.	A	B	C	D	Weight Range - Kgs. /12'
5301	40.00	18.00	10.00	0.70	0.900 - 1.100
5302	40.00	18.00	10.00	0.91	1.100 - 1.300
5303	40.00	18.00	10.00	1.05	1.300 - 1.500
5304	40.00	18.00	10.00	1.18	1.500 - 1.700
5305	40.00	18.00	10.00	1.45	1.700 - 1.900
5306	40.00	18.00 </td <td>10.00</td> <td>1.50</td> <td>1.900 - 2.200</td>	10.00	1.50	1.900 - 2.200

SHUTTER - O/S/O (18MM SERIES)

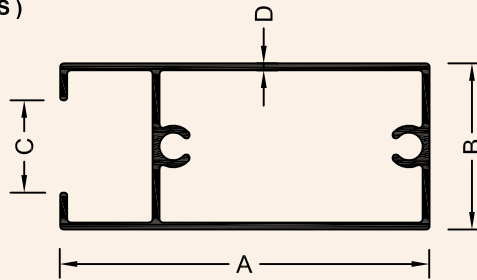

Section No.	A	B	C	D	Weight Range - Kgs. /12'
5307	40.00	18.00	10.00	0.70	0.900 - 1.100
5308	40.00	18.00	10.00	0.91	1.100 - 1.300
5309	40.00	18.00	10.00	1.05	1.300 - 1.500
5310	40.00	18.00	10.00	1.18	1.500 - 1.700
5311	40.00	18.00	10.00	1.45	1.700 - 1.900
5312	40.00	18.00	10.00	1.55	1.900 - 2.200

SHUTTER - I/L (18MM SERIES)

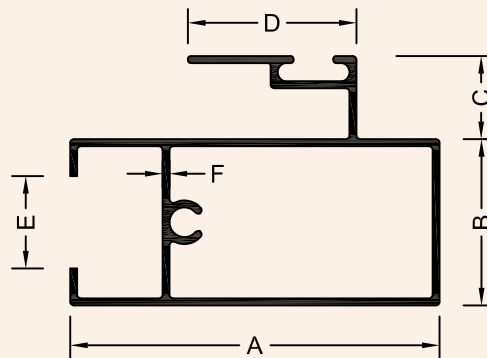

Section No.	A	B	C	D	E	F	Weight Range - Kgs. /12'
5313	40.00	18.00	9.00	18.25	10.00	0.80	1.200 - 1.400
5314	40.00	18.00	9.00	18.25	10.00	0.90	1.400 - 1.600
5315	40.00	18.00	9.00	18.25	10.00	1.05	1.600 - 1.800
5316	40.00	18.00	9.00	18.25	10.00	1.20	1.800 - 2.000
5317	40.00	18.00	9.00	18.25	10.00	1.35	2.000 - 2.200

2- TRACK SIDE & TOP (18MM SERIES)

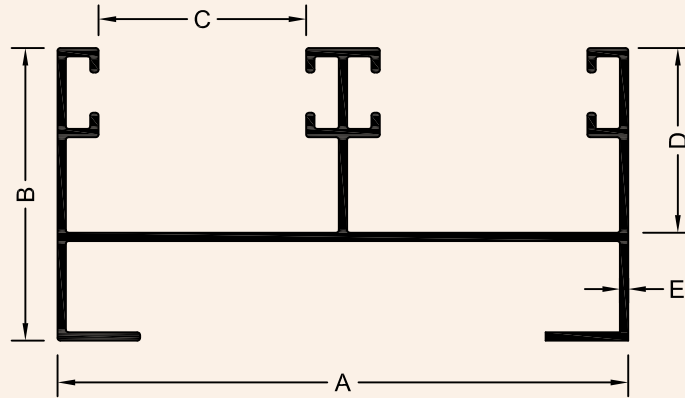

Section No.	A	B	C	D	E	Weight Range - Kgs. /12'
5401	61.79	31.69	22.48	20.00	0.87	1.500 - 1.750

2 - TRACK BOTTOM (18MM SERIES)

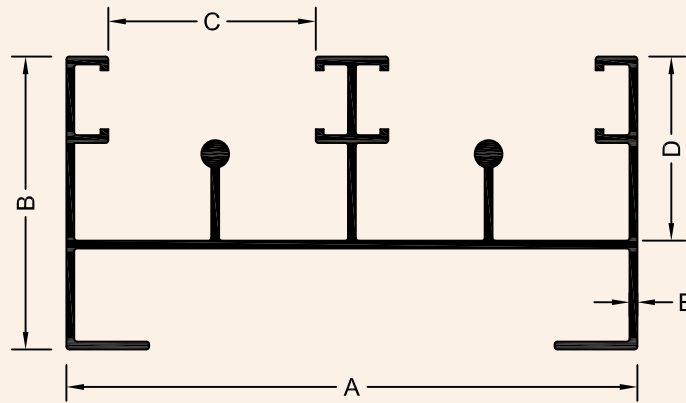

Section No.	A	B	C	D	E	Weight Range - Kgs. /12'
5402	61.81	31.71	22.46	19.93	0.80	1.750 - 2.000

2 - TRACK BOTTOM (20MM SERIES)

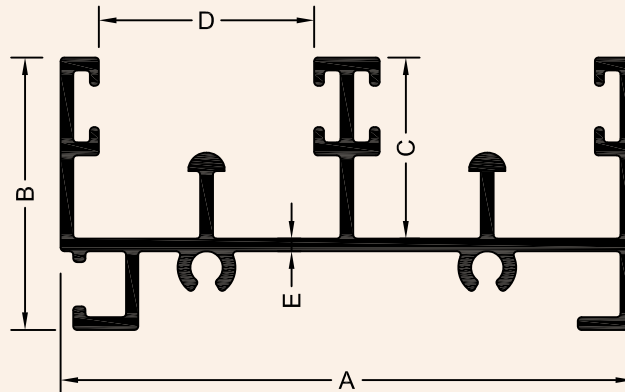

Section No.	A	B	C	D	E	Weight Range - Kgs. /12'
5403	62.00	29.50	19.60	23.31	0.75	1.750 - 2.000
5404	62.00	29.50	19.60	23.31	0.90	2.000 - 2.250
5405	62.00	29.50	19.60	23.31	1.00	2.250 - 2.500

2- TRACK SIDE & TOP (20MM SERIES)

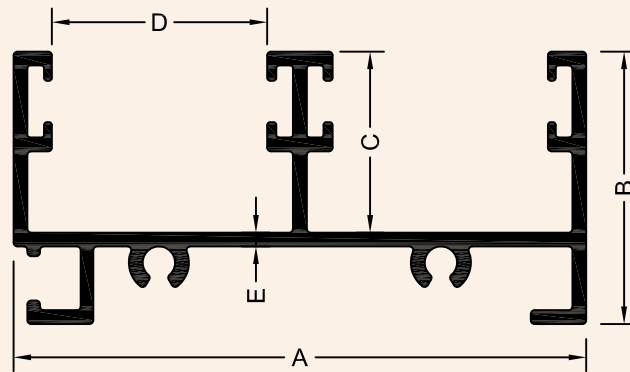

Section No.	A	B	C	D	E	Weight Range - Kgs. /12'
5406	62.00	29.50	19.60	23.31	0.90	1.750 - 2.000
5407	62.00	29.50	19.60	23.31	1.00	2.000 - 2.250
5408	62.00	29.50	19.60	23.31	1.20	2.250 - 2.500
5409	62.00	29.50	19.60	23.31	1.30	2.500 - 2.750
5410	62.00	29.50	19.60	23.31	1.60	3.000 - 3.250

3- TRACK SIDE & TOP (20MM SERIES)

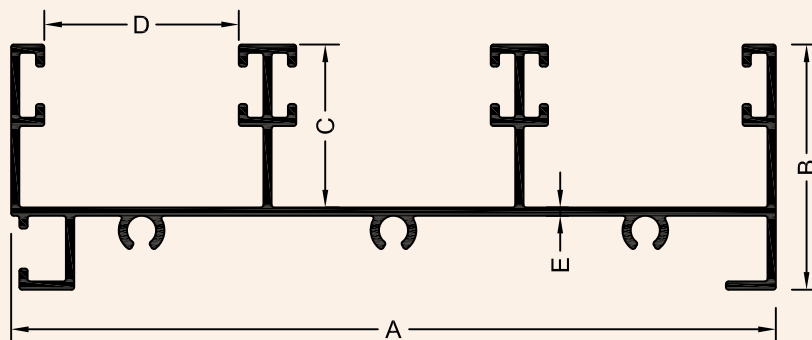

Section No.	A	B	C	D	E	Weight Range - Kgs. /12'
5411	92.00	29.50	19.60	23.40	1.05	2.750 - 3.000
5412	92.00	29.50	19.60	23.40	1.15	3.000 - 3.250
5413	92.00	29.50	19.60	23.40	1.25	3.250 - 3.500
5414	92.00	29.50	19.60	23.40	1.50	3.800 - 4.200

3 - TRACK BOTTOM (20MM SERIES)

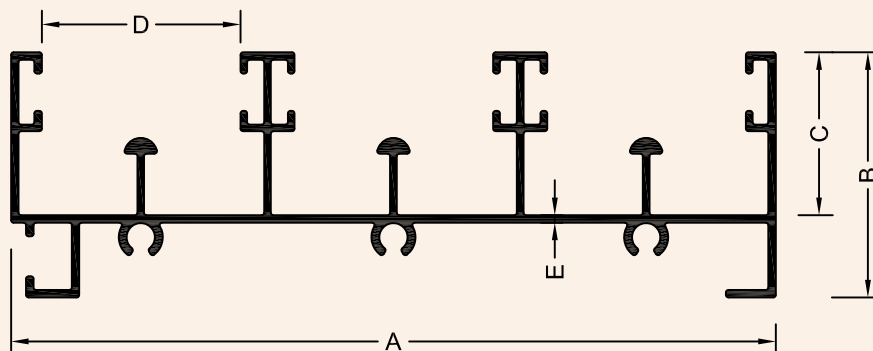

Section No.	A	B	C	D	E	Weight Range - Kgs. /12'
5415	92.00	29.50	19.60	23.90	0.80	2.275 - 3.000
5416	92.00	29.50	19.60	23.90	0.95	3.000 - 3.250
5417	92.00	29.50	19.60	23.90	1.70	4.300 - 4.600

SHUTTER - B/S/O (15MM SERIES)

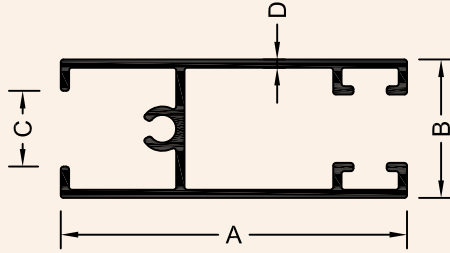

Section No.	A	B	C	D	Weight Range - Kgs. /12'
5318	37.50	15.00	8.20	0.95	1.000 - 1.200
5319	37.50	15.00	8.30	1.15	1.200 - 1.400
5320	37.50	15.00	8.30	1.40	1.400 - 1.600

SHUTTER - I/L (15MM SERIES)

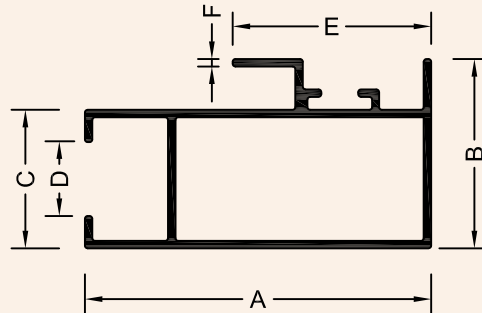

Section No.	A	B	C	D	E	F	Weight Range - Kgs. /12'
5321	37.50	20.50	15.00	8.00	21.50	0.81	1.000 - 1.200
5322	37.50	20.50	15.00	8.20	21.50	1.00	1.200 - 1.400
5323	37.50	20.50	15.00	8.20	21.50	1.20	1.400 - 1.600

2 - TRACK SIDE & TOP (15MM SERIES)

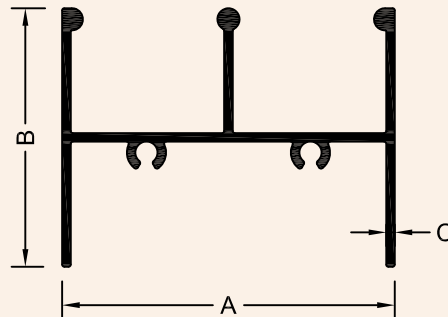

Section No.	A	B	C	Weight Range - Kgs. /12'
5418	45.00	35.00	0.65	1.000 - 1.200
5419	45.00	35.00	0.80	1.200 - 1.400
5420	45.00	35.00	0.95	1.400 - 1.600
5421	45.00	35.00	1.10	1.600 - 1.800
5422	45.00	35.00	1.25	1.800 - 2.000

CASEMENT WINDOW

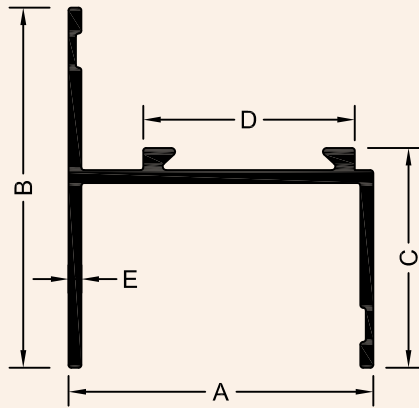

Section No.	A	B	C	D	E	Weight Range - Kgs. /12'
5501	33.00	39.00	23.80	22.90	1.40	1.200 - 1.350
5502	33.00	39.00	23.80	22.90	1.60	1.650 - 1.800

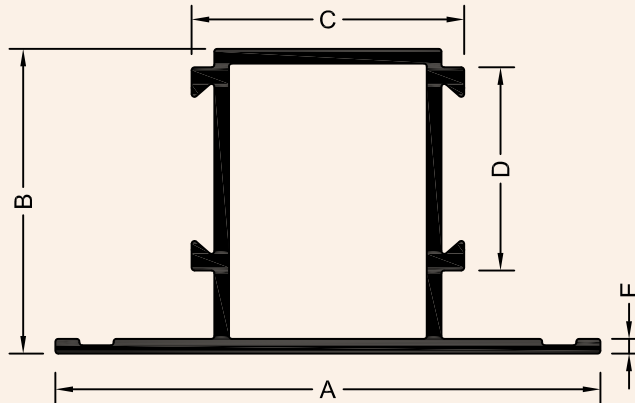

Section No.	A	B	C	D	E	Weight Range - Kgs. /12'
5503	59.00	33.00	29.50	22.00	1.60	2.400 - 2.600

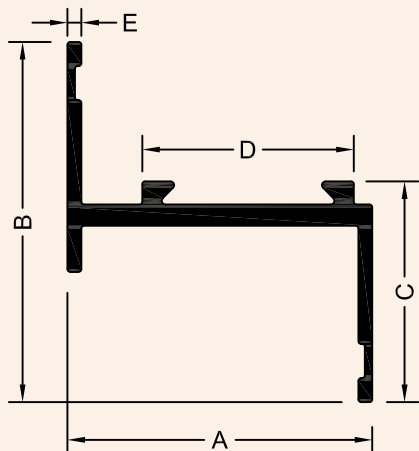

Section No.	A	B	C	D	E	Weight Range - Kgs. /12'
5504	33.00	39.00	23.90	22.90	1.50	1.500 - 1.650

1 3/4" CURTAIN WALL - 6mm RIB

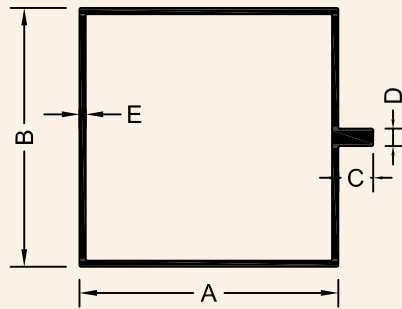

Section No.	A	B	C	D	E	Weight Range - Kgs. /12'
6000	44.50	44.50	6.00	3.00	1.05	1.800 - 2.100
6001	44.50	44.50	6.00	3.00	1.22	2.100 - 2.400
6002	44.50	44.50	6.00	3.00	1.40	2.400 - 2.700
6003	44.50	44.50	6.00	3.00	1.65	2.800 - 3.200

1 3/4" CURTAIN WALL - 10mm RIB

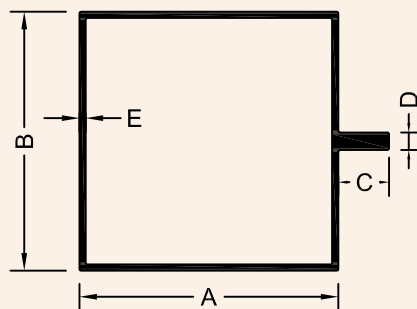

Section No.	A	B	C	D	E	Weight Range - Kgs. /12'
6004	44.50	44.50	10.00	10.00	0.95	2.550 - 2.750

2 1/2" CURTAIN WALL - 10mm RIB

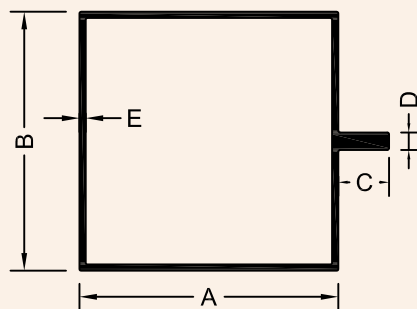

Section No.	A	B	C	D	E	Weight Range - Kgs. /12'
6005	63.00	56.00	10.00	3.00	1.20	3.000 - 3.250
6006	63.00	56.00	10.00	3.00	1.35	3.250 - 3.500
6007	63.00	56.00	10.00	3.00	1.45	3.500 - 3.750
6008	63.00	56.00	10.00	3.00	1.55	3.750 - 4.000
6009	63.00	56.00	10.00	3.00	1.75	5.000 - 5.500

SKY LIGHT BOTTOM

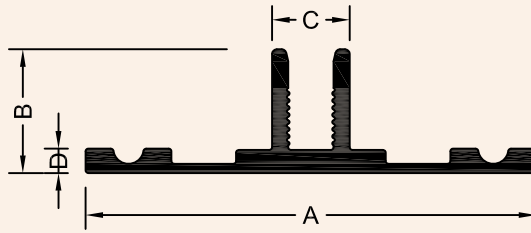

Section No.	A	B	C	D	Weight Range - Kgs. /12'
1301	48.80	13.40	8.40	2.65	1.200 - 1.350
1302	48.80	13.40	8.40	2.80	1.350 - 1.500

SKY LIGHT TOP

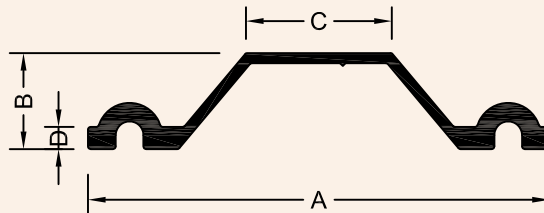

Section No.	A	B	C	D	Weight Range - Kgs. /12'
1303	50.00	10.40	15.80	2.40	0.900 - 1.100
1304	50.00	10.40	15.80	2.70	1.100 - 1.250

MODULAR FURNITURE

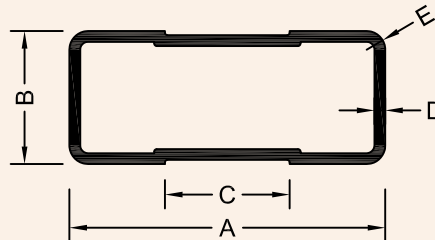

Section No.	A	B	C	D	E	Weight Range - Kgs. /12'
5600	38.00	16.00	15.00	1.30	R 2.25	1.250 - 1.450

LOUVER

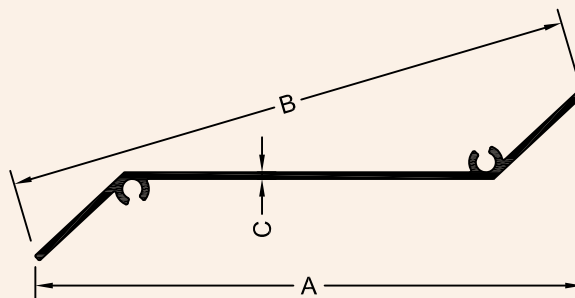

Section No.	A	B	C	Weight Range - Kgs. /12'
5701	110.00	114.38	1.20	1.600 - 1.800
5702	112.10	116.80	1.70	2.100 - 2.400

A/C GRILL

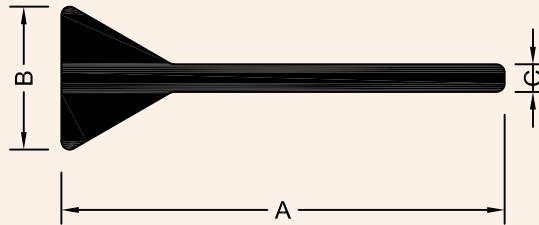

Section No.	A	B	C	Weight Range - Kgs. /12'
6301	16.00	5.16	1.00	0.216 - 0.310

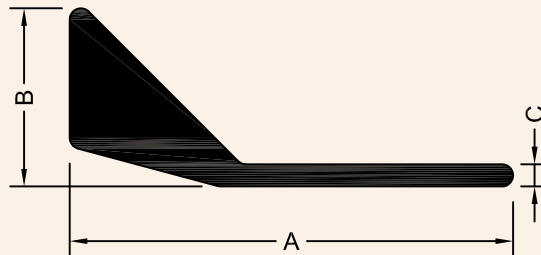

Section No.	A	B	C	Weight Range - Kgs. /12'
6302	16.00	6.43	0.80	0.230 - 0.330

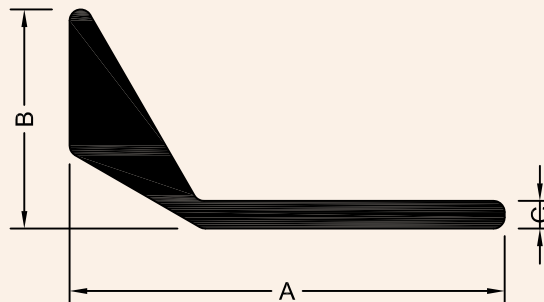

Section No.	A	B	C	Weight Range - Kgs. /12'
6303	15.70	7.91	1.00	0.240 - 0.340

SOLAR PANEL

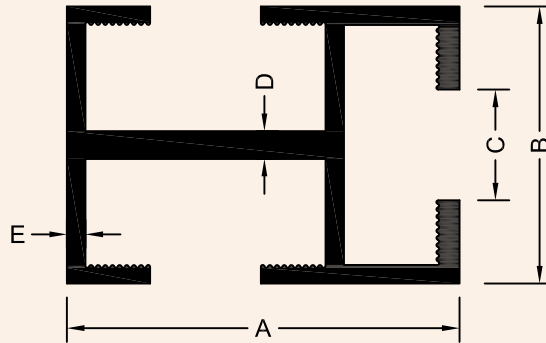

Section No.	A	B	C	D	E	Weight Range - Kgs. /12'
6101	42.50	30.00	12.00	3.00	2.00	3.200 - 3.400

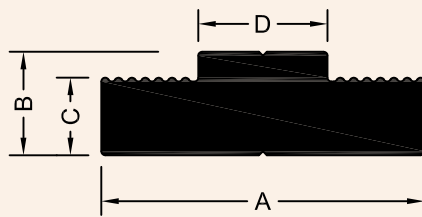

Section No.	A	B	C	D	Weight Range - Kgs. /12'
6102	25.00	8.00	6.00	10.00	1.600 - 1.800

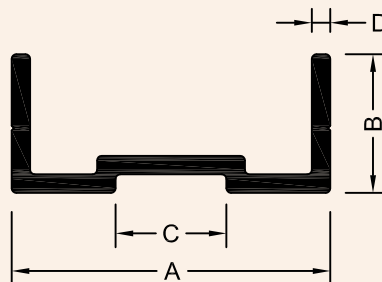

Section No.	A	B	C	D	Weight Range - Kgs. /12'
6103	34.50	15.00	12.00	2.00	1.200 - 1.400

SOLAR PANEL

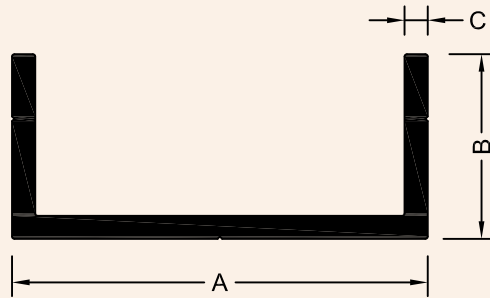

Section No.	A	B	C	Weight Range - Kgs. /12'
6104	45.00	20.00	2.50	1.700 - 1.900

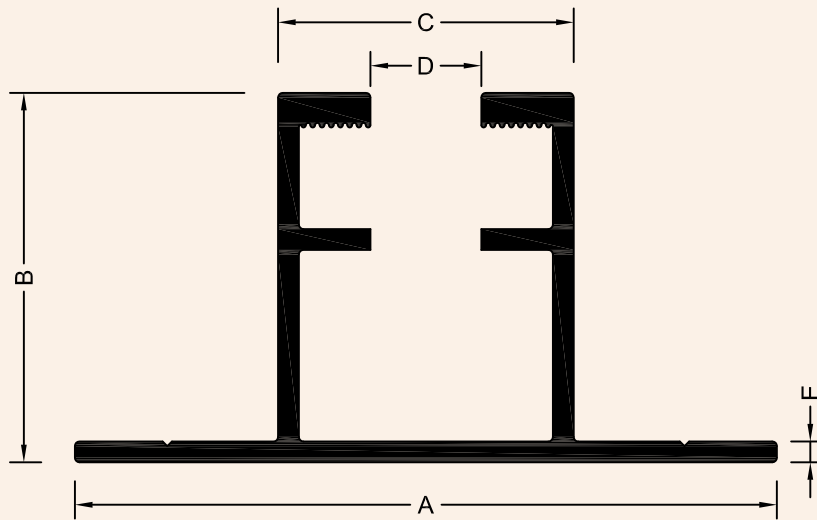

Section No.	A	B	C	D	E	Weight Range - Kgs. /12'
6105	76.00	40.00	32.00	12.00	2.25	4.100 - 4.400

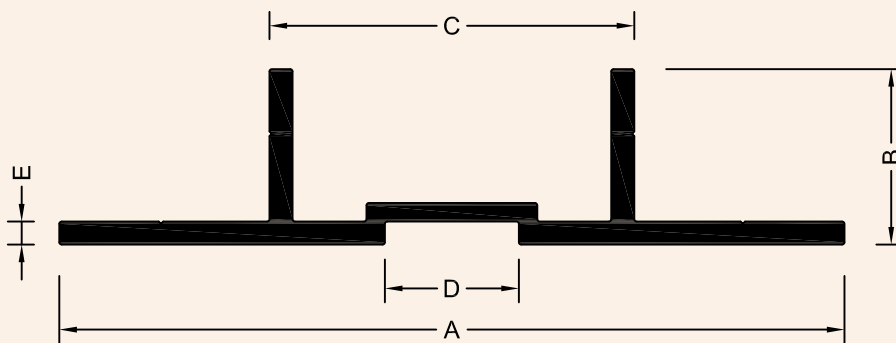

Section No.	A	B	C	D	E	Weight Range - Kgs. /12'
6106	85.00	19.00	39.50	14.50	2.50	4.100 - 4.400

SOLAR PANEL

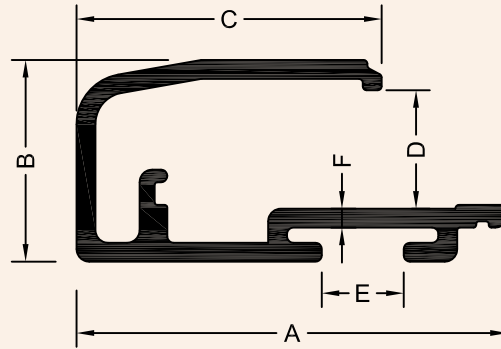

Section No.	A	B	C	D	E	F	Weight Range - Kgs. /12'
6203	34.20	16.00	24.20	9.40	6.50	1.50	1.200 - 1.400

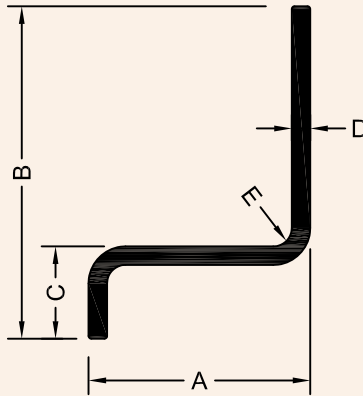

Section No.	A	B	C	D	E	Weight Range - Kgs. /12'
6107	24.00	36.00	10.00	2.00	R-2	1.000 - 1.200

SOLAR

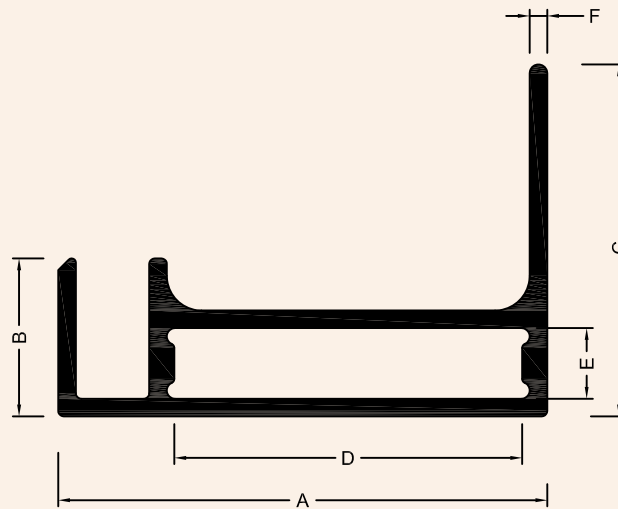

Section No.	A	B	C	D	E	F	Weight Range - Kgs. /12'
6108	35.30	11.40	25.40	25.10	5.10	1.27	1.300 - 1.500

SOLAR PANEL

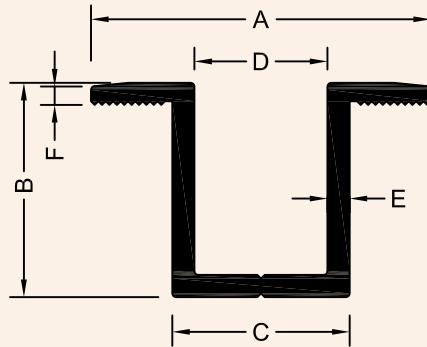

Section No.	A	B	C	D	E	F	Weight Range - Kgs. /12'
6109	46.00	29.00	24.00	18.0	3.00	2.50	2.600 - 3.000

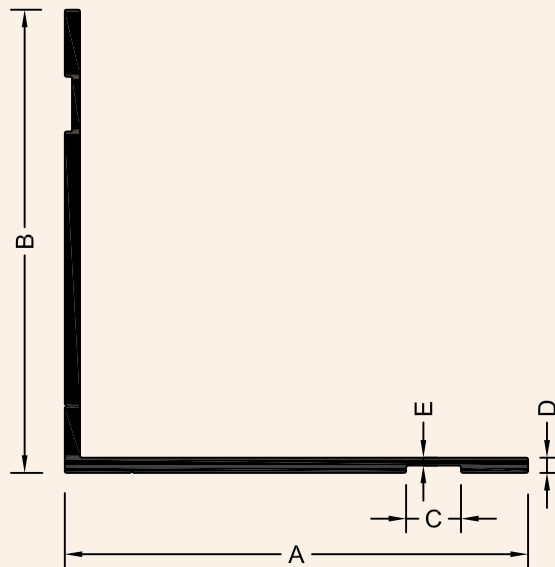

Section No.	A	B	C	D	E	Weight Range - Kgs. /12'
1018	76.00	76.00	9.00	2.50	1.30	3.350 - 3.550

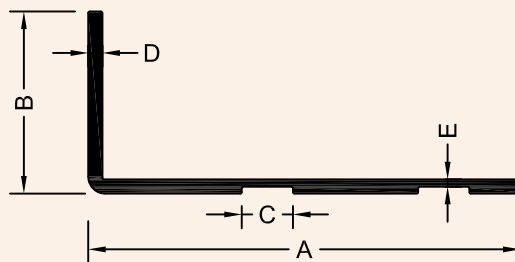

Section No.	A	B	C	D	E	Weight Range - Kgs. /12'
1019	76.00	32.00	9.00	2.50	1.30	2.350 - 2.550

INDUSTRIAL

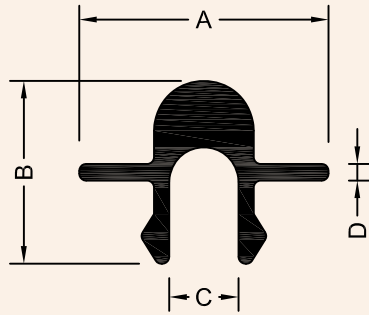

Section No.	A	B	C	D	Weight Range - Kgs. /12'
5901	9.00	6.60	2.50	0.60	0.150 - 0.250

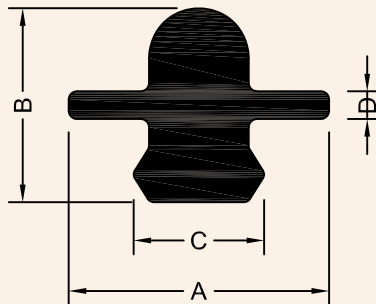

Section No.	A	B	C	D	Weight Range - Kgs. /12'
5902	9.40	7.00	4.80	1.00	0.250 - 0.350

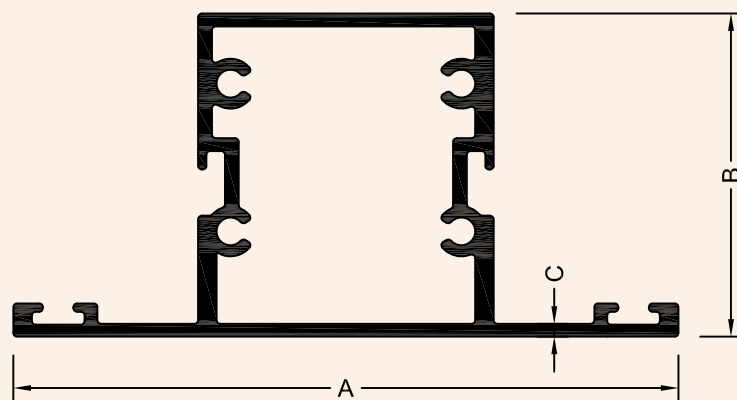

Section No.	A	B	C	Weight Range - Kgs. /12'
6200	72.00	35.00	1.40	3.000 - 3.400

INDUSTRIAL

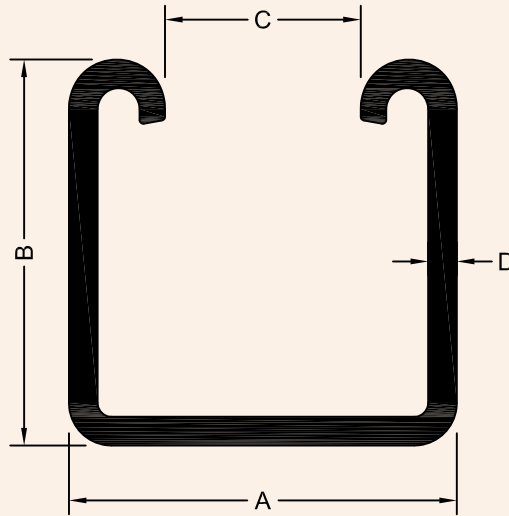

Section No.	A	B	C	D	Weight Range - Kgs. /12'
6201	42.00	41.80	21.20	3.11	3.900 - 4.300

SUPERMARKET SECTION

'F' SECTION

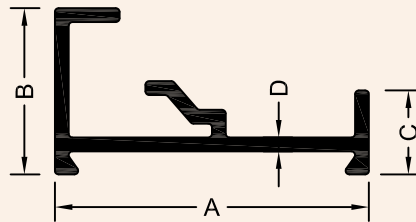

Section No.	A	B	C	D	Weight Range - Kgs. /12'
5903	34.00	18.00	9.10	1.10	0.750 - 0.900
5904	34.00	18.00	9.10	1.25	0.900 - 1.050
5905	34.00	18.00	9.10	1.50	1.050 - 1.200
5906	34.00	18.00	9.10	2.00	1.400 - 1.550

G SECTION

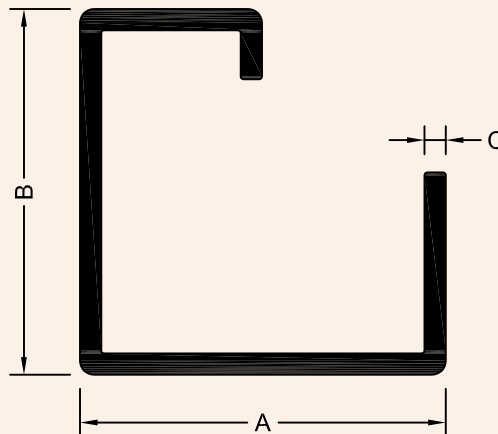

Section No.	A	B	C	Weight Range - Kgs. /12'
5423	39.60	39.60	2.30	3.000 - 3.250
5424	39.60	39.60	3.50	3.750 - 4.000

**TRANSPORT
HALF ROUND**

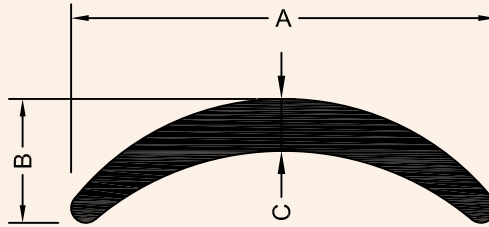

Section No.	A	B	C	Weight Range - Kgs. /12'
3000	23.00	6.70	2.80	0.550 - 0.650

RADIUS FLAT

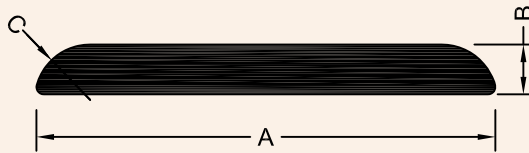

Section No.	A	B	C	Weight Range - Kgs. /12'
3001	25.00	2.70	R-3	0.580 - 0.680

PATHWAY BEADING

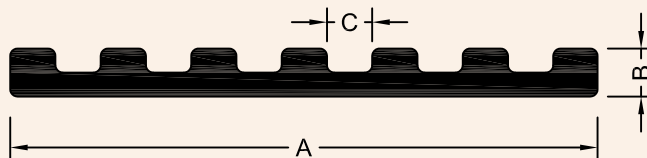

Section No.	A	B	C	Weight Range - Kgs. /12'
3002	31.80	2.60	2.45	0.575 - 0.675

**TRANSPORT
MAZDA SECTION**

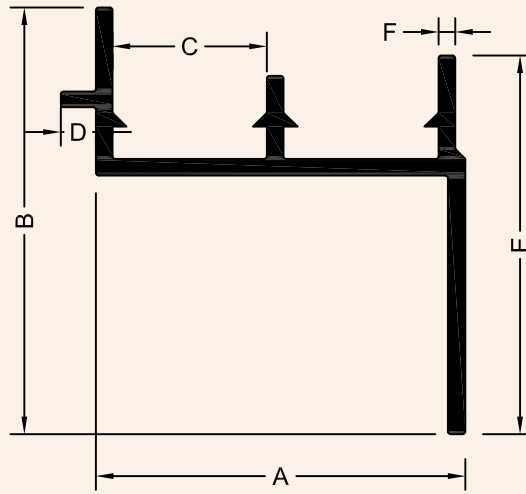

Section No.	A	B	C	D	E	F	Weight Range - Kgs. /12'
3003	40.00	46.20	16.70	3.80	41.00	1.60	1.700 - 2.000
3004	40.00	46.20	16.70	3.80	41.00	1.90	2.000 - 2.200
3005	40.00	46.20	16.70	3.80	41.00	2.10	2.200 - 2.400
3006	40.00	46.20	16.70	3.80	41.00	2.25	2.400 - 2.600

HI TECH MAZDA SECTION

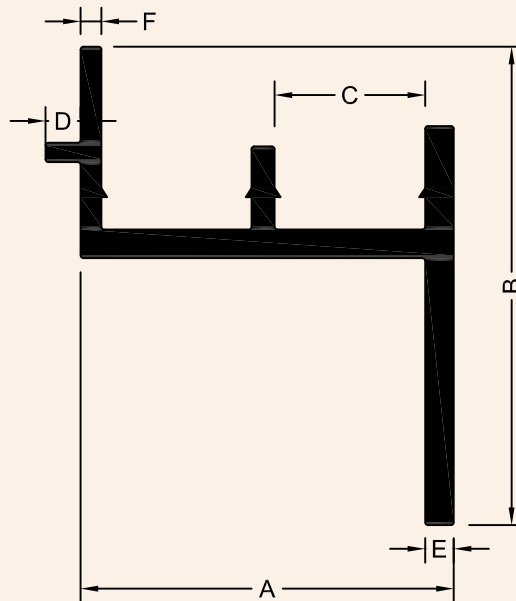

Section No.	A	B	C	D	E	F	Weight Range - Kgs. /12'
3007	40.40	51.80	16.30	3.80	2.20	2.10	2.300 - 2.500
3008	40.40	51.80	16.30	3.80	3.10	2.50	3.200 - 3.400
3009	40.40	51.80	16.30	3.80	3.40	2.50	3.400 - 3.600

**TRANSPORT
ANDRA MAZTA**

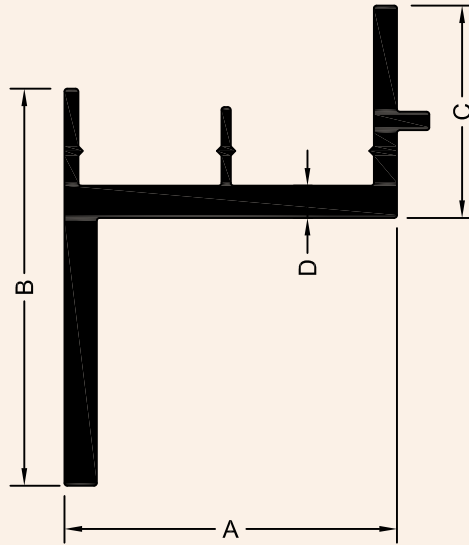

Section No.	A	B	C	D	Weight Range - Kgs. /12'
3010	36.00	43.00	23.00	3.50	2.900 - 3.100

ANDRA MAZTA

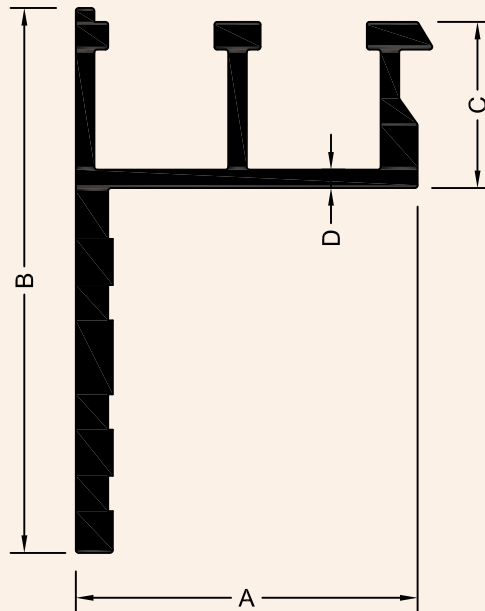

Section No.	A	B	C	D	Weight Range - Kgs. /12'
3011	37.00	59.00	18.00	2.00	3.450 - 3.650

**TRANSPORT
DICK BEADING**

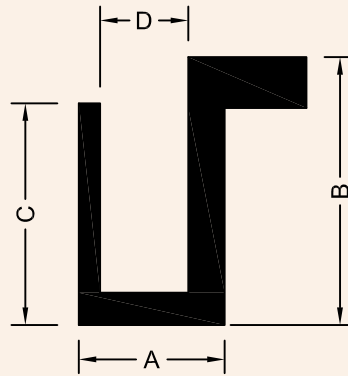

Section No.	A	B	C	D	Weight Range - Kgs. /12'
3012	15.80	29.00	24.00	9.55	2.400 - 2.600

VOLVO SECTION

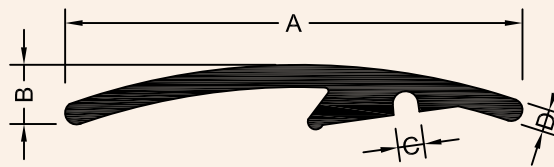

Section No.	A	B	C	D	Weight Range - Kgs. /12'
3013	49.50	6.80	2.80	2.50	1.400 - 1.600

HI TECH VOLVO SECTION

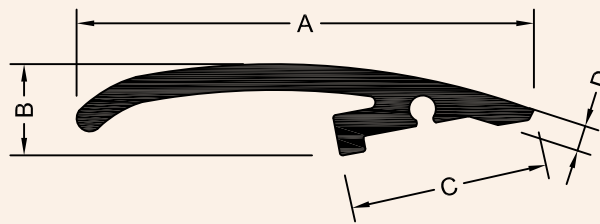

Section No.	A	B	C	D	Weight Range - Kgs. /12'
3014	49.60	10.00	21.50	2.90	1.600 - 1.750

ACP BEADING

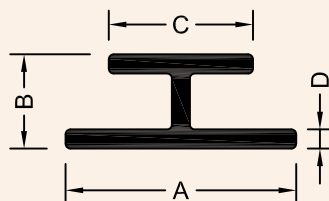

Section No.	A	B	C	D	Weight Range - Kgs. /12'
3015	19.20	7.85	12.00	1.60	0.480 - 0.640

**TRANSPORT
C CHANNEL**

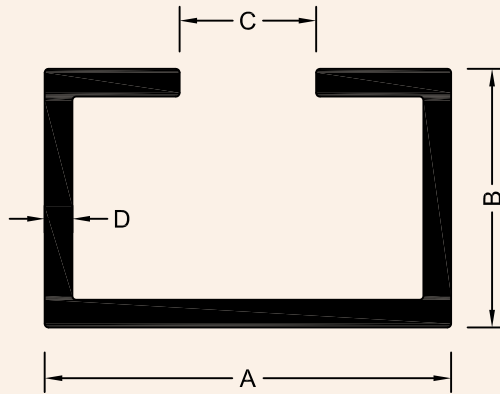

Section No.	A	B	C	D	Weight Range - Kgs. /12'
3016	22.00	14.00	7.40	1.50	0.750 - 0.900

STEP ANGLE

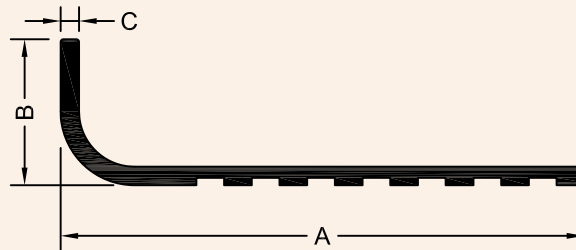

Section No.	A	B	C	Weight Range - Kgs. /12'
3017	56.70	15.80	2.00	1.080 - 1.230

STEP ANGLE

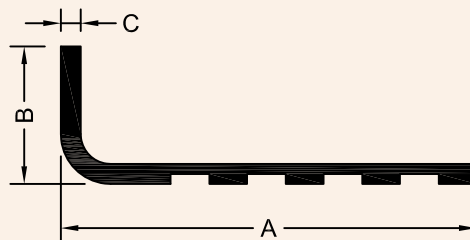

Section No.	A	B	C	Weight Range - Kgs. /12'
3018	37.50	12.40	1.80	0.625 - 0.775

**TRANSPORT
SOOTING H**

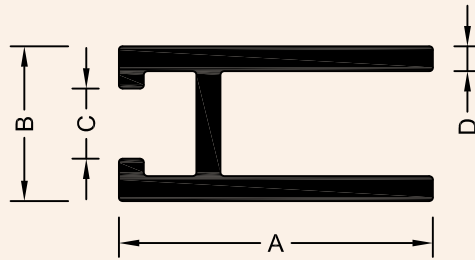

Section No.	A	B	C	D	Weight Range - Kgs. /12'
3019	17.00	8.38	3.80	1.35	0.480 - 0.630

KEY GOLA

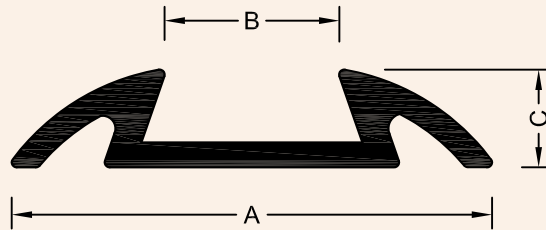

Section No.	A	B	C	Weight Range - Kgs. /12'
3020	29.20	10.20	5.90	0.600 - 0.700

J - WATER CHANNEL

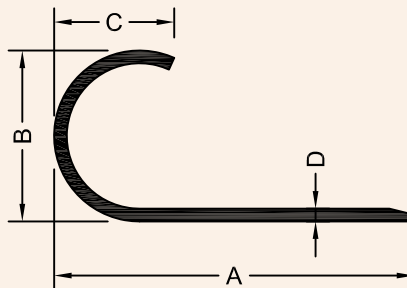

Section No.	A	B	C	D	Weight Range - Kgs. /12'
3021	39.00	18.50	13.00	1.38	0.750 - 0.850

RAIL COACH

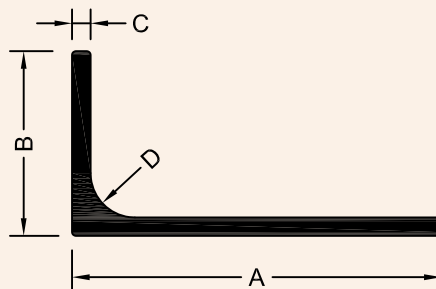

Section No.	A	B	C	D	Weight Range - Kgs. /12'
1017	40.00	20.00	2.00	R 4.8	1.100 - 1.300

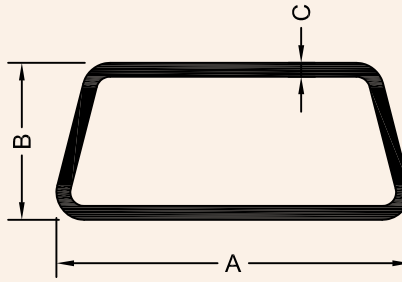

Section No.	A	B	C	Weight Range - Kgs. /12'
5601	38.27	17.00	1.50	1.300 - 1.500

**ROMAN BLINDS
(SCREENS)**

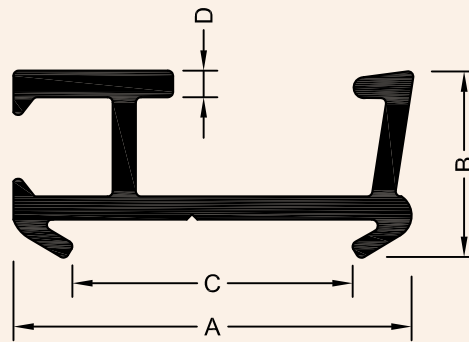

Section No.	A	B	C	D	Weight Range - Kgs. /12'
5700	22.30	10.00	15.70	1.50	0.600 - 0.750

NETLON

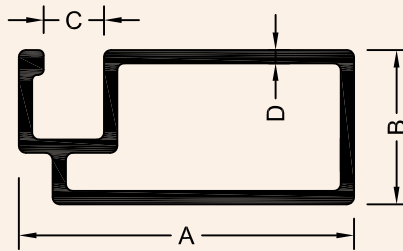

Section No.	A	B	C	D	Weight Range - Kgs. /12'
5800	18.90	8.70	3.40	0.75	0.370 - 0.470

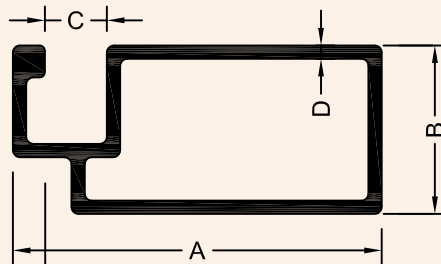

Section No.	A	B	C	D	Weight Range - Kgs. /12'
5801	20.80	9.50	3.50	0.75	0.400 - 0.500

MOSQUITO NET

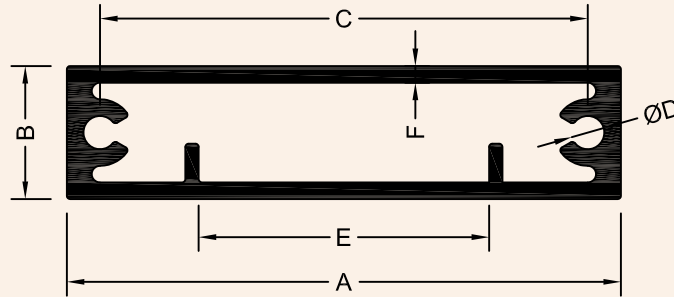

Section No.	A	B	C	ØD	E	F	Weight Range - Kgs. /12'
5802	50.00	12.00	44.00	3.00	26.20	1.50	2.050 - 2.200

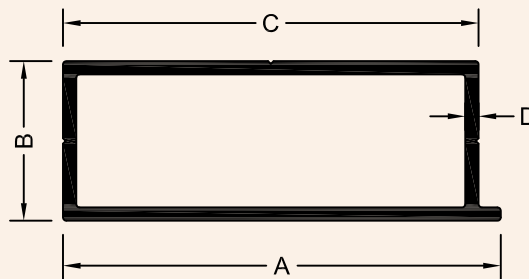

Section No.	A	B	C	D	Weight Range - Kgs. /12'
5803	39.50	14.40	37.50	1.20	1.100 - 1.250

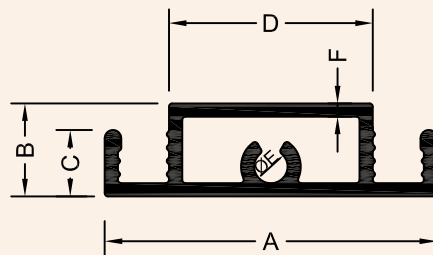

Section No.	A	B	C	D	ØE	F	Weight Range - Kgs. /12'
5804	30.00	8.40	6.00	18.40	3.00	1.20	0.850 - 1.000

MOSQUITO NET

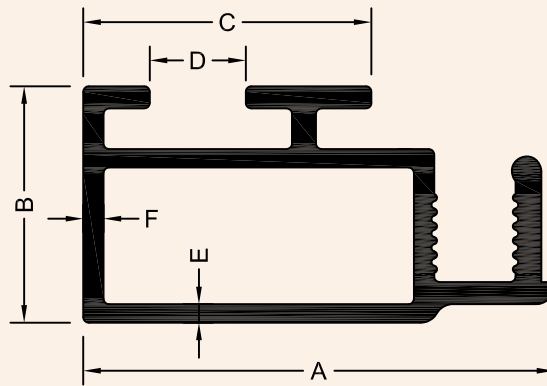

Section No.	A	B	C	D	E	F	Weight Range - Kgs. /12'
5805	25.50	12.80	15.60	5.20	1.00	1.10	0.850 - 0.950

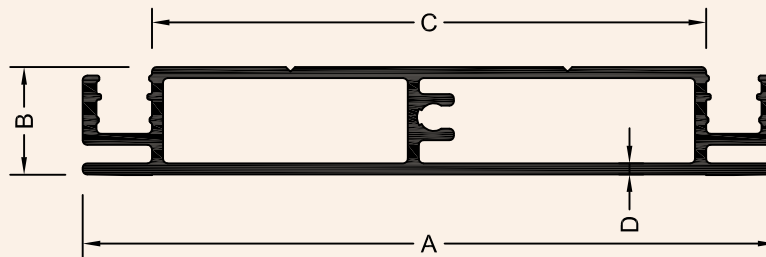

Section No.	A	B	C	D	Weight Range - Kgs. /12'
5806	75.00	11.70	60.00	1.20	2.300 - 2.500

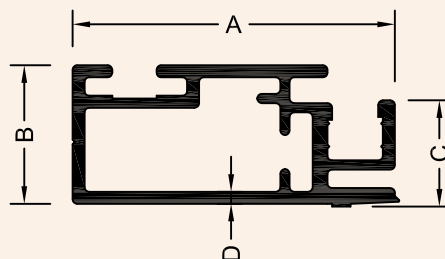

Section No.	A	B	C	D	Weight Range - Kgs. /12'
5807	34.90	15.00	11.50	1.30	1.450 - 1.650